

# THE PROPOSED MIXED-USE DEVELOPMENT ON ERF 2187, THREE ANCHOR BAY TREE SURVEY

## TREE SURVEY & PROTECTION SUMMARY

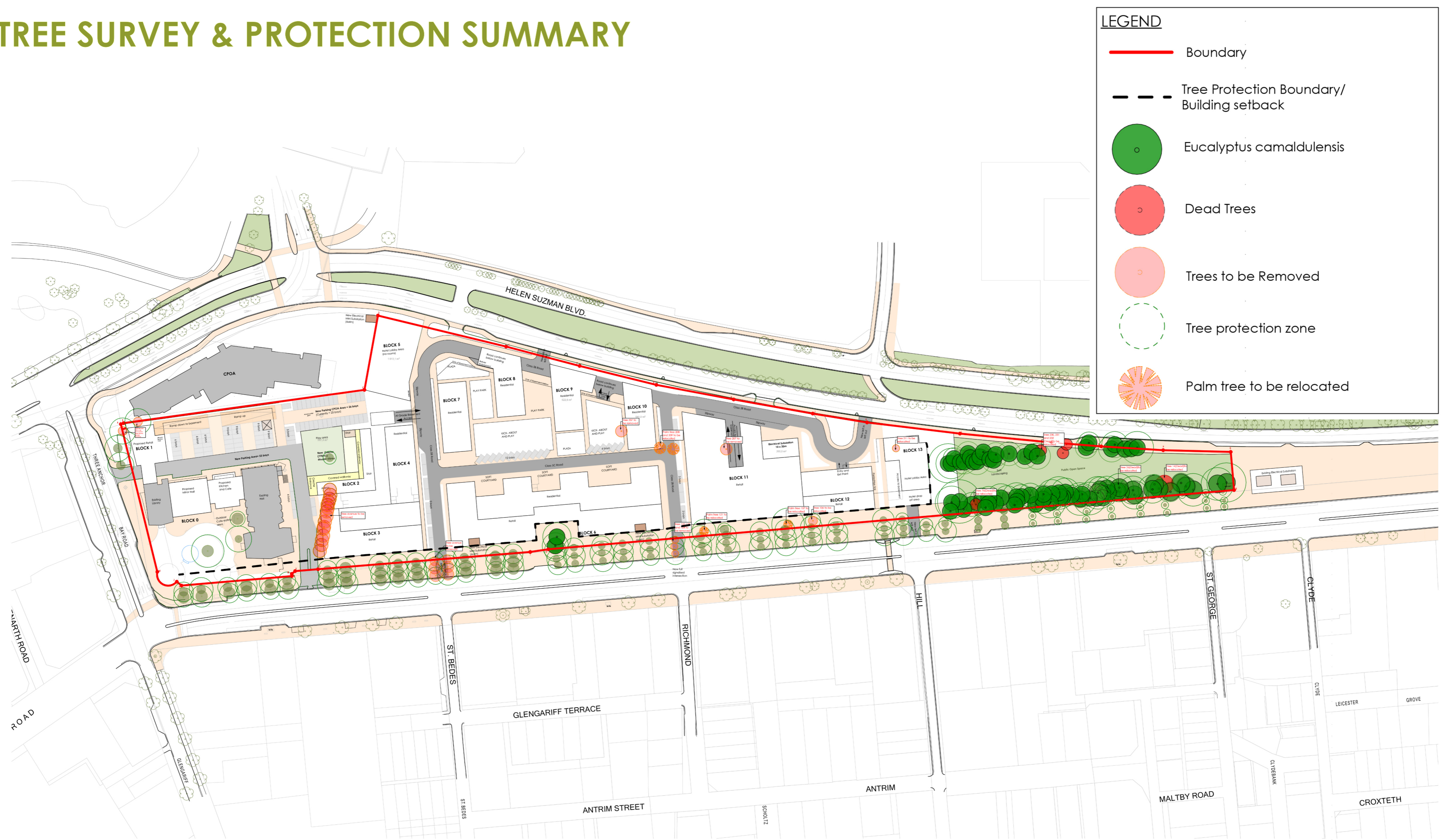

### KEY

- Retail
- Residential
- Basement
- Pedestrian Pathways
- Tree Root Protection Zone
- Green Space

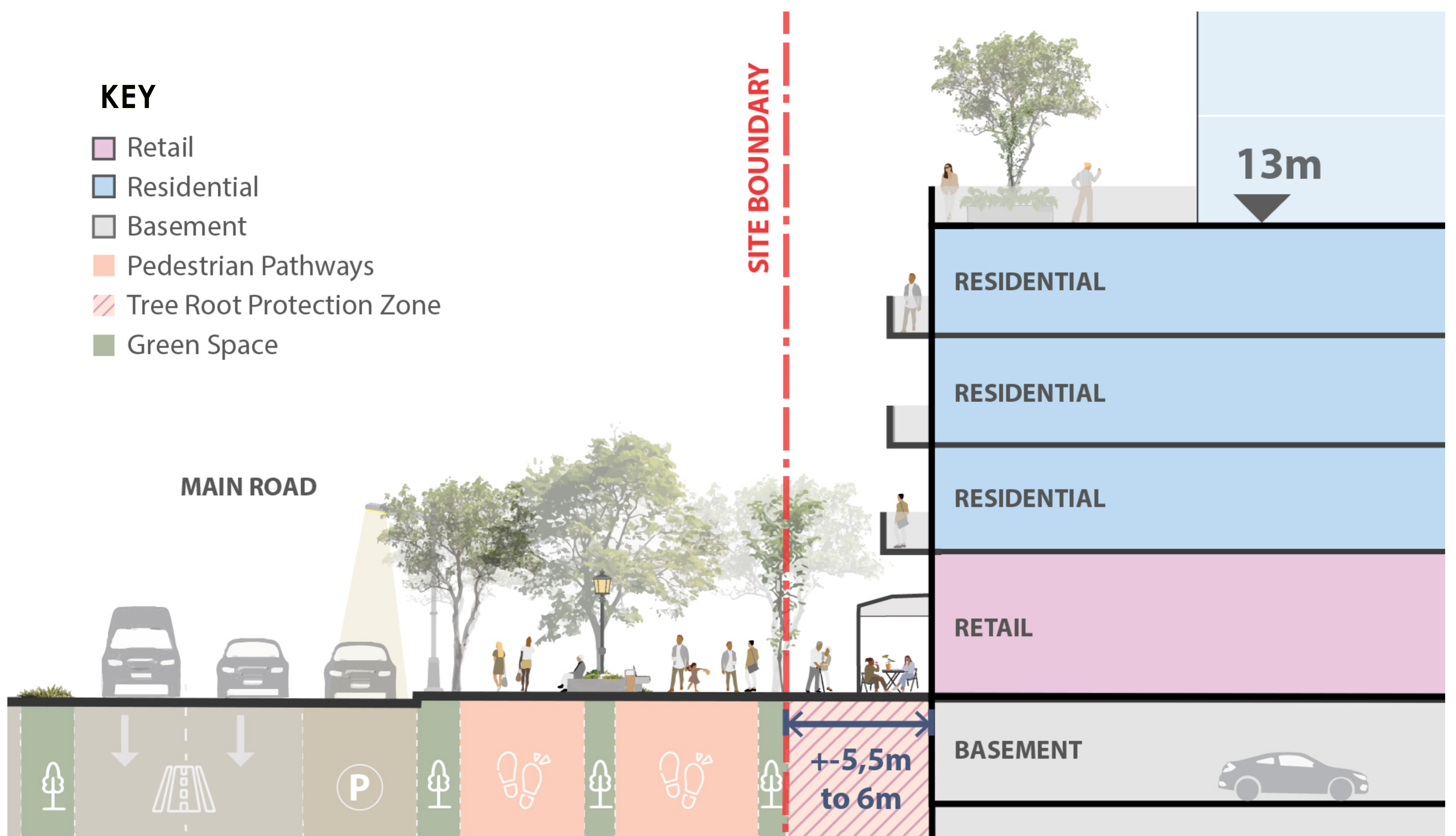

The above illustrates a cross-section of a +/- 5.5m to 6m Tree Protection Zone (TPZ) from the site boundary, resulting in the appropriate development setback